

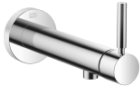

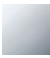





36 804 661

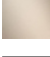

- 160mm projection
- fixed spout
- circular, air-enriched flow
- hole diameter 60 mm
- rosette Ø 78 mm
- max. flow 5.7 l/min
- lead-free
- with single-point mounting
- This product can help a building meet the requirements of Green Building Rating Systems, e.g. LEED®, BREEAM®, DGNB

	Chrome	36 804 661-00
	Brushed Platinum	36 804 661-06
	Dark Chrome	36 804 661-19
	Light Gold	36 804 661-26
	Brushed Light Gold	36 804 661-27
	Matte Black	36 804 661-33
	Brushed Bronze	36 804 661-42
	Brushed Champagne (22kt Gold)	36 804 661-46
	Champagne (22kt Gold)	36 804 661-47
	Brushed Chrome	36 804 661-93
	Brushed Dark Platinum	36 804 661-99

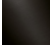
Required miscellaneous

- | | | |
|---|----------------------------------|---------------|
|  | Concealed wall mounting - | 35 003 970 90 |
| | •max. recess depth 103 mm | |
| | •min. recess depth 78 mm | |

36 804 661

mm [inches]

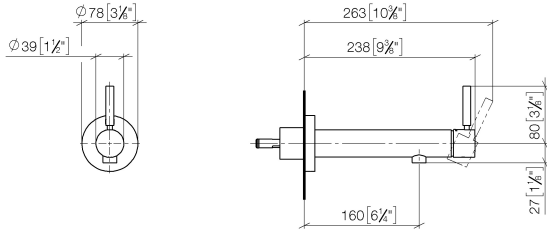

Flow rate chart



Certificates

LGA_19462.

DVGW_DW-
6512DN0127.

WRAS_2003025.

36 804 661

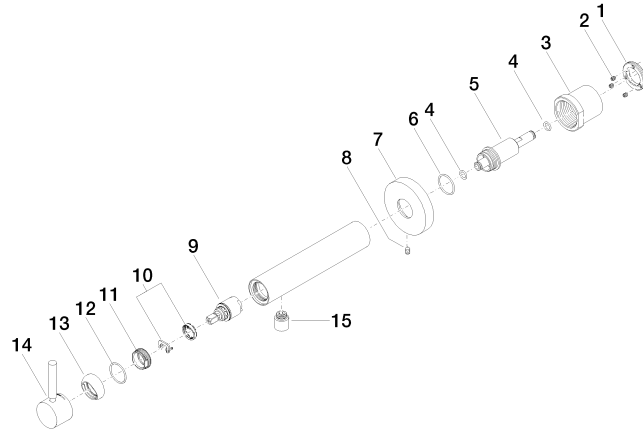

Spare parts list

No.	Item Number	Name	Quantity used	Delivery time
1	09 24 77 002 90	nut	1	2
2	90 31 11 030 00 90	pin	3	2
3	09 21 02 128 90	sleeve	1	2
4	09 14 10 139 90	seal	2	2
5	09 24 04 210 10 90	nipple	1	2
6	90 14 10 063 00 90	seal	1	2
7	09 27 88 009-00	rosette	1	10
8	09 31 11 144 90	pin	1	2
9	90 15 05 044 00 90	cartridge	1	2
10	90 28 10 148 00 90	accessories	1	2
11	09 24 04 266 90	nut	1	2
12	09 14 10 120 90	seal	1	2
13	09 28 30 043-00	cover	1	10
14	90 20 66 024 00-00	handle	1	10
15	90 23 01 168 00-00	aerator	1	10